

Installation Instructions Skid Pads for Slider Windows

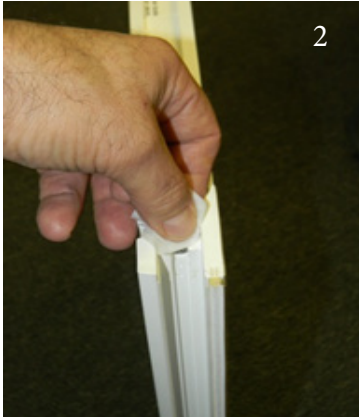

1. Remove active panel from frame and turn upside-down so rollers are visible.

2. Clean both ends of sash with supplied alcohol and dry with clean lint free cloth (as shown).

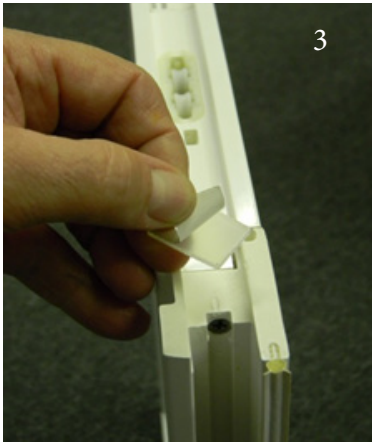

3. Completely remove liner from skid pad as shown.

4. Align Skid pad with edge of sash and press firmly until the pad appears clear.

5. Finished Placement

